

COME JOIN US
At
THE 35th ANNUAL
FLORIDA CONFERENCE OF VOLUNTEERS
SERVING THE VISUALLY IMPAIRED
May 3- 5, 2010

VISUAL AID VOLUNTEERS OF FLORIDA, INC.
“Dedication Makes the Difference”

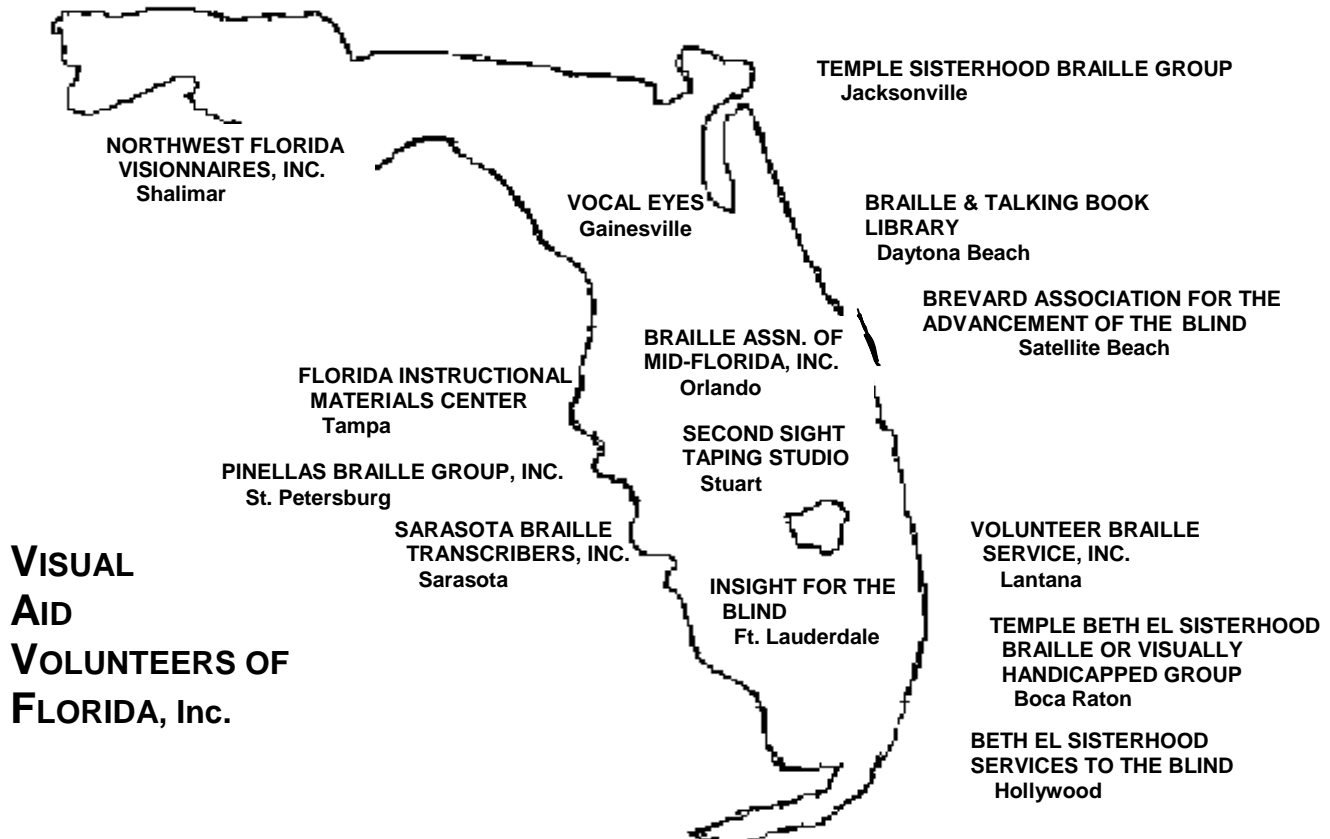

HAWTHORN SUITES BY WINDHAM ORLANDO AIRPORT
7450 AUGUSTA NATIONAL DRIVE
ORLANDO, FL 32822
Phone: 407-438-2121 or 866-878-4175
Fax: 407-438-2275

www.hawthornsuitesairport.com

APH:

American Printing House for the Blind

BANA:

Braille Authority of North America

CASC:

Computer Applications Specialties Company, Inc. (Dr. Robert Stepp)

CVI:

Center for the Visually Impaired

FIMC:

Florida Instructional Materials Center

NBA:

National Braille Association, Inc.

NIMAS:

National Instructional Materials Accessibility Standards

VAVF:

Visual Aid Volunteers of Florida, Inc.

**THE CIRCUS IS COMING
STARRING
THE WORLD FAMOUS VAVF VOLUNTEERS**

**THREE RINGS
PACKED WITH SOLID INFORMATION
FOR THREE DAYS**

SEATING IS SUBJECT TO REGISTRATION

The location, once again, is Hawthorn Suites Orlando Airport. Be sure to read ALL the enclosed information ... you'll be amazed and amused ... then, contact Hawthorn Suites and make your reservation ... and be SURE to get your discounted money to the lovely VAVF treasurer as she awaits the opening act of this year's conference!

Add to the excitement of three rings of information coming to you at any one time by joining together in the main tent for our annual luncheon on Monday ... just tell us your food preference ... and we'll make sure the lions and tigers will be off in another cage so you can't hear them roar.

Follow the elephant parade, nose to tail, as they march to Orlando for the VAVF Conference. When the ringmaster blows the whistle to start the show you need to be in your seat. Be sure to register right now while you've got the information in your hand.

DON'T walk the high wire of indecision ... DO make your registration NOW.

Registration Information: Call the hotel at 1-866-878-4175 to make the reservation mentioning VAVF. One person from each room will send Arlene Jensen (6425 Streamport Dr., Orlando, FL 32822) a check made payable to VAVF for \$99/\$95 per night. VAVF will pay the hotel for all rooms on the master list. When making the reservation, a credit card number is needed. All hotels (all over the world) require a credit card number, even though the basic room charge of \$99 is paid by a master account (VAVF in this case). The card would cover any additional charges to the room for which the occupant is responsible.

Come and join us for an exciting 2010 VAVF Conference. Remember:

1. Make your hotel reservation NOW and send the check to Arlene Jensen before 04/18/10 to be included on the master list. (Latecomers will have to pay market rates + tax).
2. Be sure to sign up for the VAVF luncheon.
3. Send in Conference registration with a check, for Conference, luncheon AND hotel NOW. (One check can cover all the fees and room costs).

The second floor map where the Meeting Rooms are located. There is elevator access to the upper floors

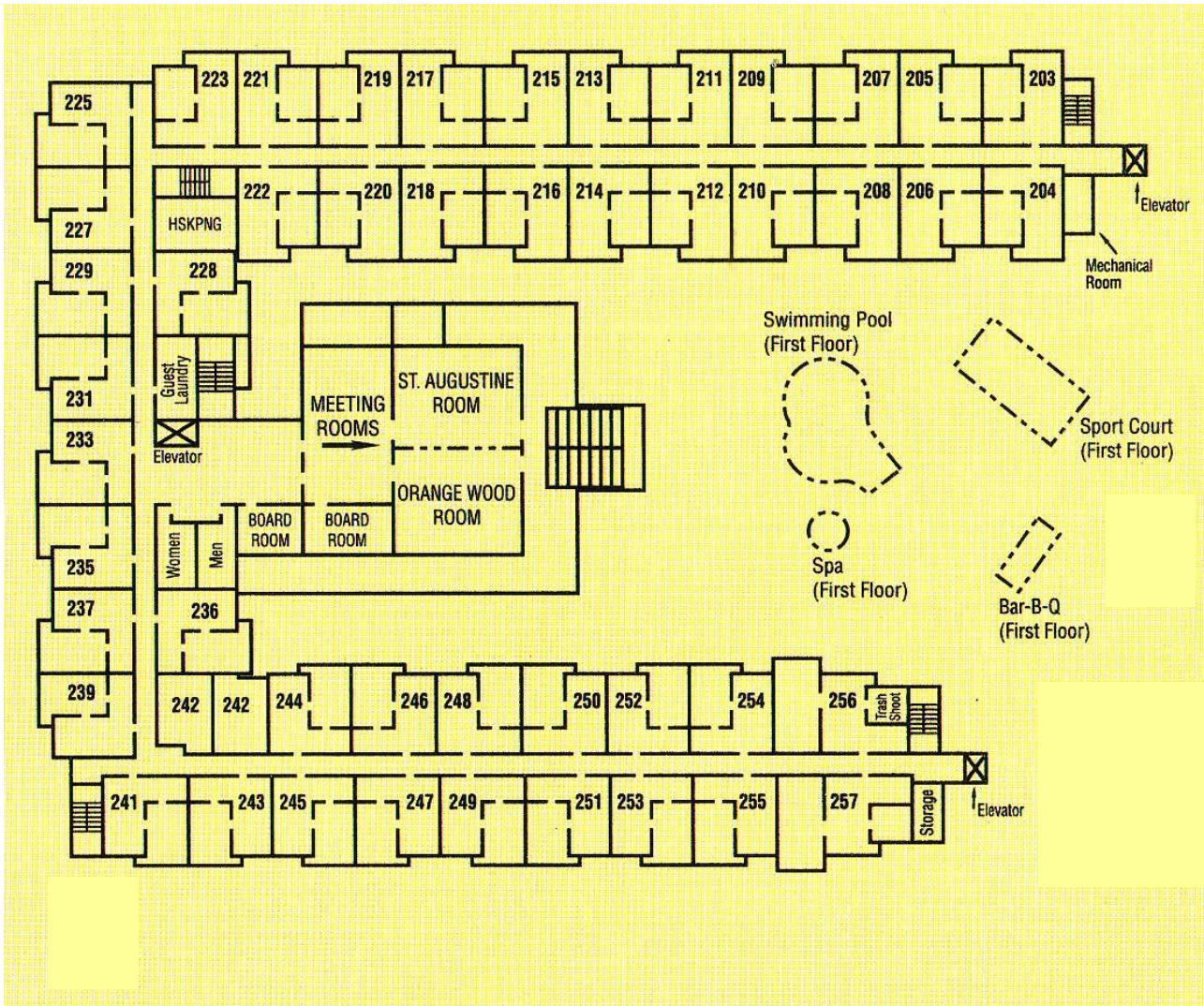

The dining room is on the first floor under the meeting rooms. Complimentary coffee is available 24 hours outside the dining room. There is a small store behind the hotel registration desk.

Directions to the Hawthorn Suites By Windham Orlando Airport

7450 Augusta National Drive
Orlando, FL 32822
Tel: (407) 438-2121
Fax: (407) 438-2275

From I-95:

Take exit 260B to merge onto I-4 W toward Orlando. Take exit 101AB toward Sanford/International Airports. Merge onto Central Florida Greenway/SR 417 South bound (101 B). SR 417 is a toll way. Take exit 26 for SR 528-TOLL-WEST toward Int'l Airport; merge onto SR 528 West bound. SR 528 west or the Beachline (old Beeline) is a toll way. Take the exit 11A to merge onto S Semoran Blvd/SR 436 North bound. **Do not take the airport exit.** Travel North on Semoran Blvd/SR 436 N less than a 1/4 of a mile to the 1st light, turn right onto TG Lee Blvd. Go to the stop sign and turn right on Augusta National Drive. The Hawthorn Suites is approximately 1/4 mile on your right across from the pond.

From the Airport by Car

Exit from airport on SR 436 North (Semoran Blvd). Travel north on Semoran Blvd/SR 436 N less than a 1/4 of a mile to the 1st light, turn right onto TG Lee Blvd. Go to the stop sign and turn right on Augusta National Drive. The Hawthorn Suites is approximately 1/4 mile on your right across from the pond.

From Airport by Shuttle

There is a shuttle available from the hotel. Phone hotel at (407) 438-2121 to arrange pick-up.

From Florida Turnpike, Either Direction

Take Exit for Beachline (old Beeline) Expressway (528) going East bound. The Beachline is a toll way. Travel East on the Beachline to the exit for Semoran Blvd (SR 436) and go North on Semoran Blvd. Travel North on Semoran Blvd less than a 1/4 of a mile to the 1st light, turn right onto TG Lee Blvd. Go to the stop sign and turn right on Augusta National Drive. The Hawthorn Suites is approximately 1/4 mile on your right across from the pond.

From Interstate 4

Coming into town from the West (Tampa area), Exit on to the Beachline (old Beeline) Expressway heading East. The Beachline is a toll way. If coming into town from the North/East, take the Florida Turnpike exit and go South. From the Florida Turnpike, take the Beachline Expressway exit and go East. Stay on the Beachline heading towards the airport. Take the exit for Semoran Blvd (SR 436) North bound. **Do not take the airport exit.** Travel North on Semoran Blvd less than a 1/4 of a mile to the 1st light, turn right onto TG Lee Blvd. Go to the stop sign and turn right on Augusta National Drive. The Hawthorn Suites is approximately 1/4 mile on your right across from the pond.



Hotel Location

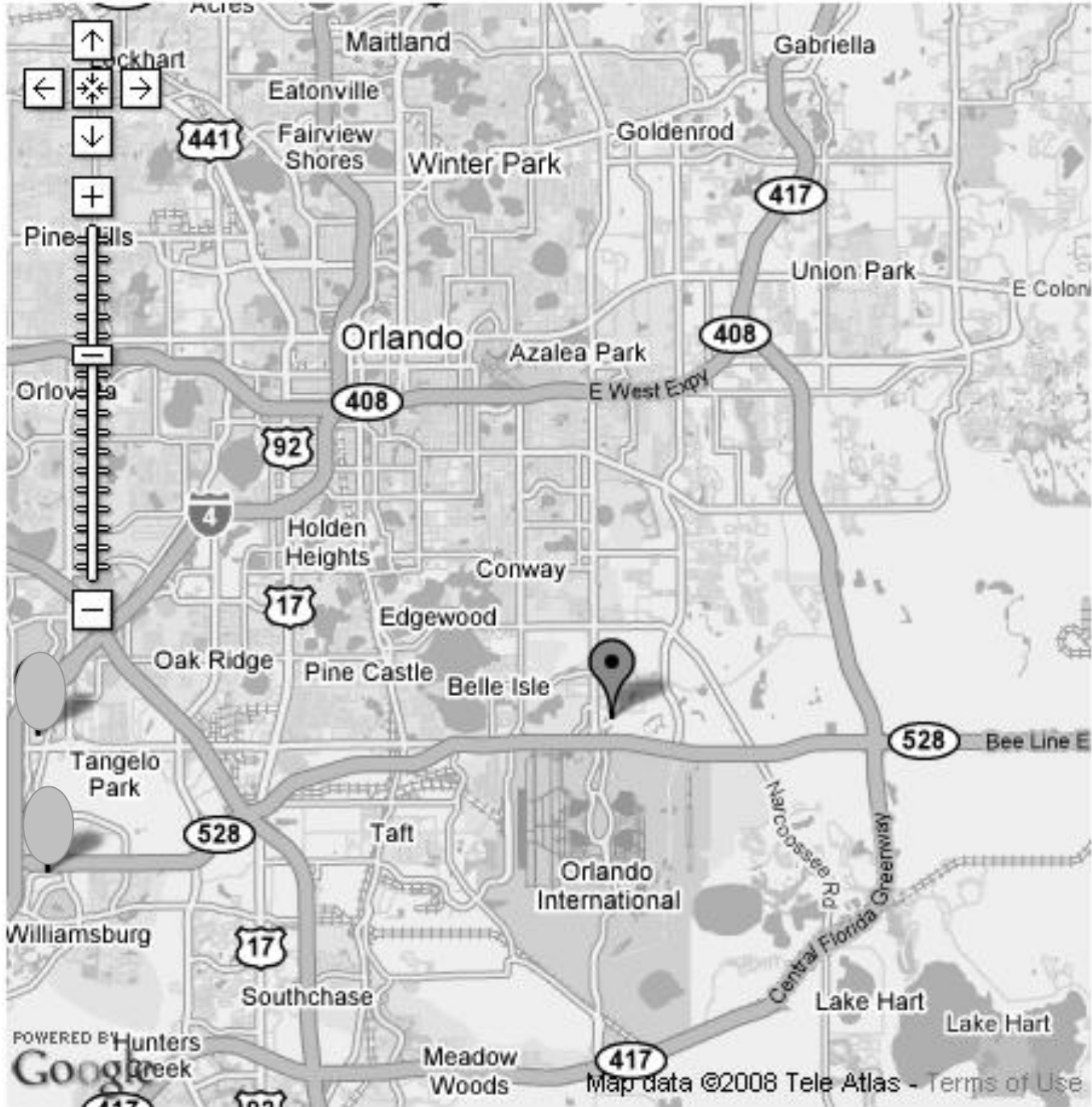

WORKSHOP DESCRIPTIONS

MONDAY, MAY 3, 2010

Please note that sessions are different lengths of time. Some are three hours long while others are for a shorter time. Longer sessions are in two parts, identified by A and B.

Time	Session and Description
8:30-10:00 AM	<p>Session 101: Basic Nemeth [Room A] Angela Brewer This workshop will cover how Nemeth is produced for grades K-2. We will discuss what to do with all those bunny rabbits and puppy dogs, whether the material is single- or double-spaced, page numbering, and BANA Updates. Bring a pen and paper...and for all you rule-oriented transcribers, bring your code books!</p>
	<p>Session 102-A: Braille2000: Version 2 [Room B] Dr. Bob Stepp A guide to using Braille2000 Version 2, beta release. The two most interesting new techniques relate to NIMAS file processing and to table formatting (for NIMAS and rtf data). This workshop will cover all that is new in the beta release (NIMAS will be mentioned, but will not be the focus of the discussion).</p>
	<p>Session 103: Groping for Graphics [Room C] Susie Coleman When a rush request comes in for a graphic and you remember you have a master for it that can be used with perhaps just some label changes, the challenge is "Where did we put it!" Come see how we keep track of our masters, blanks, and samples. We input the info into a user-friendly library catalog software program. Bring your curiosity, hints, and suggestions.</p>
10:00-10:30 AM	BREAK
10:30-12:00	<p>Session 104: Advanced Nemeth [Room A] Angela Brewer Come join us as we discuss the format of Nemeth code for grades 3-12. We will also discuss the BANA updates as it relates to Nemeth code. Bring a pen and paper...and for all you rule-oriented transcribers, bring your code books!</p>
	<p>Session 102-B: Braille2000: Version 2 (cont.) [Room B] Dr. Bob Stepp</p>
	<p>Session 105: Graphic Analysis [Room C] Ruth Jean Ostle Actual illustrations from print texts will be presented. Methods of portraying these illustrations in braille transcriptions will be discussed.</p>

12:00-2:00 PM Session 106: LUNCHEON

2:00-3:30 PM Session 107: Scanning with Omni 16

[Room A] Janet Nullet

Learn to scan material, format the material in WORD 2007 and insert into BRAILLE 2000. Workshop will show shortcuts and hints to make formatting your Braille easier.

Session 108: Basic Formats

[Room B] Lynnette Taylor

For recently certified transcribers who want a basic knowledge of textbook formatting, the workshop will include FIMC requirements, workbooks, and handouts.

Session 109-A: Creating Foil Graphics

[Room C] Ruth Jean Ostle

Discussion of tactile graphics that are best presented by foil masters will be followed by step-by-step creation of a typical example. This is a hands-on session.

3:30-4:00 PM BREAK

4:00-5:30 PM Session 110: Artistic Translation

[Room A] Leon Pettersen, Elliott Whitman & Lynnette Taylor

How do you describe illustrations that can't be presented as a graphic. The workshop will be suitable for both braillists and recorders. Please bring samples of graphics.

Session 111: Braille2000 Options

[Room B] Meg Wagner & Dr. Robert Stepp

This will be mostly lecture/demonstration, but participants are welcome to bring laptops if they want to, but they are not necessary in order to attend the workshop. Are there features of Braille2000 that you haven't ever used and are wondering about? This workshop will cover topics suggested by Braille2000 users, such as the Grade Relaxer, how to adjust the keyboard response, the History feature, how to change Languages in a file, creating custom dictionaries ... If you have other topics you would like to have discussed, please let Meg know by e-mail at brlwagner@aol.com by April 10.

Session 109-B: Creating Foil Graphics (cont.)

[Room C] Ruth Jean Ostle

TUESDAY, MAY 4, 2010

Please note that sessions are different lengths of time. Some are three hours long while others are for a shorter time. Longer sessions are in two parts, identified by A and B.

Time	Session and Description
8:30-10:00 AM	<p>Session 201: Basic Braille2000 [Room A] Meg Wagner & Dr. Robert Stepp This workshop is for transcribers who have little or no experience with Braille2000. It will cover the beginning basics of Braille2000, and will not be hands-on.</p> <p>Session 202: Microsoft Office 2007; Word & Excel: Basic [Room B] David Brunick An introduction to Microsoft Word and Excel, exploring the differences between Office 2003 and Office 2007. Tips and tricks for productivity. It will demonstrate basic to intermediate level work in creating, editing, and formatting Word documents and Excel workbooks.</p> <p>Session 203-A: Hold that Tiger [Room C] Susie Coleman Do you have or plan to purchase the ViewPlus Tiger Embosser? I'm going to give you some hints and tips about which size line, color and texture, margins etc. to use. Bring your laptops and we'll play! No real tigers allowed! Laptops are not essential.</p>
10:00-10:30 AM	BREAK
10:30-12:00	<p>Session 204: Proofreading Challenge [Room A] Peg Rogaski This workshop is for the new transcriber — either students or those who are newly certified. We will be working as a team to discover new tips and proven ways to make proofreading as painless as possible. Send me any questions you have by e-mail at progaski@comcast.net and we can discuss them during the workshop.</p> <p>Session 205: Microsoft Office 2007: Word & Excel: Intermediate [Room B] David Brunick It will show intermediate to advanced functions of Word and Excel with work in Charting, Formulas (Excel) and advanced style features of Table of Contents, Headers and Footers, in Word.</p> <p>Session 203-B: Hold that Tiger (cont.) [Room C] Susie Coleman</p>

12:00-2:00 PM

LUNCH ON YOUR OWN

2:00-3:30 PM

Session 206: Literary Challenge: The Game Show

[Room A] *Mary Klein*

LITERARY CHALLENGE: THE GAME SHOW invites participants to successfully answer questions about the recent updated changes to Literary Braille and their correct usage. FUN and FAST...yet challenging; we will all learn and share our knowledge together! Just bring a pencil and your knowledge of Literary Braille.

Session 207-A: Meet Your Readers

[Room B] *Mariann Witengier*

The panel will be made up of students at various grade levels who use braille as their primary reading medium. They will be available to answer questions, gain ideas from brailleists, and share their ideas. Participants are welcome to bring in graphics, maps, various worksheets that the panelists can view and comment on regarding readability.

Session 208: Computer Braille Code

[Room C] *Joyce Hull*

The presentation will cover a review of the rules and symbols for using the Computer Braille Code. We will also examine the proper contexts in which Computer Braille Code is required in the current system. I will discuss briefly the impact that the proposed new braille system (NUBS) will have on CBC.

3:30-4:00 PM

BREAK

4:00-5:30 PM

Session 209: Manuscript

[Room A] *Chuck Lueck, Kathleen McCallum & Blanche Waller*

A panel and audience question and answer period concerning the manuscript. The panel will consist of members who have recently been certified or are working on their manuscript.

Session 207-B: Meet Your Readers (cont.)

[Room B] *Mariann Witengier*

Session 210: Nemeth Uniform Braille System (NUBS)

[Room C] *Joyce Hull*

Introduction to the new braille system (NUBS) now being evaluated by BANA. Although NUBS is designed to replace the current literary, Nemeth, and Computer Braille Codes; in this workshop, we will cover only the literary aspects of the system, using examples that compare the current code with the proposed NUBS.

WEDNESDAY, MAY 5, 2010

***Please note that sessions are different lengths of time.
Some are three hours long while others are for a shorter time.
Longer sessions are in two parts, identified by A and B.***

Time	Session and Description
8:30-10:00 AM	<p>Session 301-A: Formats Challenge [Room A] <i>Lynnette Taylor</i> A CD with a sample selection from a book will be sent to all registrants. You may braille the selection and bring the file with you to the workshop for discussion or email it to me at dandltaylor@att.net. You may opt to look over the material so that you can contribute to the discussion.</p>
	<p>Session 302: Classroom Worksheets & Tests [Room B] <i>Florence Mathiesen & Mariann Witengier</i> We will present materials created for student use. We will examine K-12 materials in all subject areas with and without graphics. Generally, worksheets and tests are created quickly and may or may not follow standard textbook formatting practice. We will view how this affects the reader and how this braille, often called "Down and Dirty" has wide usage due to the volume and time factors. Hopefully, this session will generate a discussion that might assist others in creating such materials. Participants are welcome to bring in worksheets and tests that their local members have created.</p>
	<p>Session 303: Mentoring [Room C] <i>Pat Gray</i> Suggestions for mentoring Braille class completers towards certification. Take the steps to success: Inspire, Buddy System, Practice, Confidence and Motivation. We'll share ideas that have worked and problems your group has encountered. If you would like to contribute suggestions or ideas, even if you are unable to attend, contact me at irishpgray@yahoo.com</p>
10:00-10:30 AM	BREAK

10:30-12:00 PM **Session 301-B: Formats Challenge (cont.)**
[Room A] *Lynnette Taylor*

Session 304: Foreign Language Rules
[Room B] *Florence Mathiesen*

The purpose of this Workshop is to review Foreign Language Format Rules with stress on Major Changes to be adopted in 2010. Information will be taken from a draft of the 2010 Rules

Session 305: Literary Nemeth
[Room C] *Joyce Hull*

The presentation will deal with circumstances in which some mathematical elements occur in a literary text. If these elements are impossible to transcribe using the current literary code, some escape may be useful. We will discuss some ideas on how to handle such mathematical elements when you are not versed in the Nemeth Code. Also, we will suggest a few of the most basic aspects of the Nemeth Code that might get you through some of these dilemmas.

CONFERENCE OVER

MONDAY	May 3, 2010	Time	Room A	Room B	Room C
		8:30--10:00	101: Basic Nemeth Angela Brewer	102-A: Braille2000: Version 2 Dr. Robert Stepp	103: Groping for Graphics Susie Coleman
		10:00--10:30	BREAK		
		10:30--12:00	104: Advanced Nemeth Angela Brewer	102-B: Braille2000: Version 2 (continued) Dr. Robert Stepp	105: Graphic Analysis Ruth Jean Ostle
		12:00--2:00	106: LUNCHEON		
		2:00--3:30	107: Scanning with Omni 16 Janet Nullet	108: Basic Formats Lynnette Taylor	109-A: Creating Foil Graphics Ruth Jean Ostle
		3:30--4:00	BREAK		
		4:00--5:30	110: Artistic Translation Leon Pettersen, Elliott Whitman & Lynnette Taylor	111: Braille2000 Options Meg Wagner & Dr. Robert Stepp	109-B: Creating Foil Graphics (continued) Ruth Jean Ostle

		<i>Time</i>	<i>Room A</i>	<i>Room B</i>	<i>Room C</i>
		TUESDAY	May 4, 2010	8:30--10:00	201: Basic Braille2000 Meg Wagner & Dr. Robert Stepp
10:00--10:30	BREAK				
10:30--12:00	204: Proofreading Challenge Peg Rogaski			205: Microsoft Office 2007: Word & Excel; Intermediate David Brunick	203-B: Hold that Tiger (continued) Susie Coleman
12:00--2:00	LUNCH ON YOUR OWN				
2:00--3:30	206: Literary Challenge: The Game Show Mary Klein			207-A: Meet Your Readers Mariann Witengier	208: Computer Braille Code Joyce Hull
3:30--4:00	BREAK				
4:00--5:30	209: Manuscript Chuck Lueck, Kathleen McCallum & Blanche Waller			207-B: Meet Your Readers (continued) Mariann Witengier	210: Nemeth Uniform Braille System (NUBS) Joyce Hull

		<i>Time</i>	<i>Room A</i>	<i>Room B</i>	<i>Room C</i>	
		WEDNESDAY	May 5, 2010	8:30--10:00	301-A: Formats Challenge Lynnette Taylor	302: Classroom Worksheets & Tests Florence Mathiesen & Mariann Witengier
10:00--10:30	BREAK					
10:30--12:00	301-B: Formats Challenge (continued) Lynnette Taylor			304: Foreign Language Rules Florence Mathiesen	305: Literary Nemeth Joyce Hull	
12:00--2:00	CONFERENCE OVER					
2:00--3:30						
3:30--4:00	BREAK					
4:00--5:30						

MEET OUR PRESENTERS

Angela Brewer

My name is Angela Brewer and I have been transcribing braille for 10 years. I am Literary, Nemeth, and NBA Braille Formats certified. My current position is Braille Coordinator for the Alternative Media Access Center, University System of Georgia, University of Georgia. I currently serve as Chair of the Membership Committee and Outreach Committee for the National Braille Association. I am still an independent contractor for various agencies around the country as well. I am also very active with the National Prison Braille Network. I have been very blessed on my journey in braille and I look forward to sharing the information about braille that has been shared with me over the years.

David Brunick

David Brunick, currently a Professor of Information Technology at Valencia Community College, has nearly 40 years' experience in the computing and telecommunications industries. He is also the Director of the Computer Programming and Information Technology Degree Programs at Valencia. He teaches various engineering courses in Computing, Networking, and Wireless infrastructures.

David is also expert in different productivity products including Microsoft Office Suite and OpenOffice by Sun Microsystems. He has taught courses in these products for the past 10 years in academic and corporate environments. David volunteers with the Braille Association of Mid-Florida as technical support.

Susie Coleman

One of the worst things in the world to me would be not to be able to read. So when I saw a newspaper article in the Jacksonville newspaper about the local braille group, I phoned one of the numbers and asked about the braille class. I was extremely shy (yes, I was so!), but Bernita Gilberstadt talked me into coming to the first class. I've been learning ever since.

I've been certified in braille transcription since 1988 and involved with graphics a year or two after that. Midge Dusenberry was, and still is, my teacher. I started out using one of the bulky gray plastic American Printing Press graphics kits (rubber pad, spur wheels, metal texture forms, etc.) and gradually added scraps of everything and anything that could be glued to paper. Ruth Jean Ostle's hands-on workshops have been so educational and inspirational. After one of Pete and Doris Schuyler's workshops, I added computer graphics as yet another way to produce braille illustrations.

When the price of Swell Touch paper went up to around \$1.29 a sheet, the Temple Sisterhood Braille Group needed to look for a cheaper method for some of the graphics. We decided to go with the ViewPlus Embosser with the Tiger software. Anything that works is my motto.

Somehow I ended up as one of VAVF's past presidents in the 1990's as well as Jacksonville's Temple Sisterhood Braille Group's president in the late 1980's. Shook in my boots every meeting. This year, I am president of TSBG again. I can handle it every 20 years or so as long as I can depend on such a great crew of members.

Pat Gray

I was born and bred in Ireland, where I married my husband, Martin, and subsequently had two children. Soon afterwards we decided to travel with work. So in 1983, my family and I moved to Libya first, then on to Abu Dhabi, Milan and finally settling in Jacksonville in 1999.

When I first came to the US, I only had a resident's visa so couldn't work. I heard the Channel 12 request for Braille volunteers which immediately sparked my interest. I went to Orientation, attended the classes and became certified in 2003.

When I got my green card and was legally allowed to work, I was so busy doing Braille, I didn't have time to work in a paid job! When Thelma said you "have to dedicate a lot of time to Braille", I had no idea what I was letting myself into but I love doing braille! I am Past-President of VAVF and I hope to be a part of this group for many years more.

Joyce Hull

After working as a systems analyst with Martin Marietta Aerospace for 27 years, I retired to find my true calling. I found braille! I had wanted to find some activity to fill my retirement years with an activity that had a real social value, but one that provided a serious mental challenge. I found that by becoming certified in literary and Nemeth. It has made my retirement years more satisfying than I could ever have imagined.

In addition to my routine transcription assignments, I taught braille transcription for 9 years and worked with Dr. Stepp on the Nemeth aspects of Braille2000. That work continues as Bob is pursuing the release of Braille2000 Version 2.00 which will incorporate the new NIMAS formats. My primary activity in the past year has been working with Dr. Nemeth in the development of his new proposed uniform braille system, NUBS, designed to replace the current literary, mathematics and computer braille codes. To provide an avenue for transcribers to try out NUBS, I began an on-line course. The seven current students are transcribing each lesson in the 2000 instruction manual using NUBS. This is working very well. I AM BUSY !! and happy!

I have four children, eight grandchildren, and two great-grands!!

Life is good.

Mary Klein

Mary Klein is a professional artist with a special interest in the fine art of cloisonné enamel. She has been working in enamel for over 35 years showing her work widely across the country and around the world. She has won numerous prizes and awards and her pieces are prized in collections around the world. She has been commissioned to create works for heads of state, such as the Sheik of Kuwait, for museum officials, such as the Directors of the Kremlin Museum, the Fondazione Memmo, and the Romer-Pelizeas Museum; and for cities, such as Takamatsu, Japan, as gifts from the City of St. Petersburg, FL.

Ms. Klein has served as President of both Ohio Designer Craftsmen and Florida Craftsmen; she sat on the Board of the Pinellas County Arts Council, and has been on the Executive Board of the Craft Emergency Relief Fund. She has been Artist-in-Residence for the Pinellas County School system for four years. In 1990, she received the coveted Friends of the Arts Award for her own work and her work as an arts advocate in the community. She has also received a Lifetime Achievement Award from Florida Craftsmen.

In 2005, Ms. Klein received her Certification in Literary Braille and has been active in the Pinellas Braille Group in St. Petersburg ever since, where she is Education Committee chair and a Board member for the past two years. She is currently teaching a class in Tactile Graphics through the PBG and expects to team-teach a class in Braille beginning in Fall 2010. She has made numerous presentations to the PBG membership on the new Braille changes and views each presentation as a learning experience not only for other people, but also for herself. She also is a firm believer in injecting fun into everything she does and Braille is no exception!

Charles “Chuck” Lueck

Charles “Chuck” Lueck was born in West Virginia, but grew up and spent the majority of his life in the Washington DC area. He is currently married to his wife Barbara of eight years, and has three sons, Christopher, David and Jesse by a prior marriage. He holds a Bachelor of Science Degree in Software Engineering, and a Masters in Business Administration.

He was employed for thirty-five years by various federal agencies, primarily in technical fields. The last twelve years of his career he spent in executive management positions in the Memphis TN, and Washington DC areas. He also served in the US Navy during the Vietnam War, from 1969 to 1971.

After his retirement in 2004, he and his wife Barbara relocated to St. Augustine FL, where they now call home.

Florence Mathiesen

I've been a braille transcriber for over 25 years. I started out as a Teacher Assistant for the Blind/Visually Impaired Program in Anchorage, Alaska where I learned braille on the job. I worked in that position until 1989.

After retirement Cliff and I traveled in our motor home for two years and finally settled in Crestview, Florida in 1991. In 1992 I joined our local volunteer group, Northwest Florida Visionnaires, and VAVF.

I am certified in both Literary Braille and Textbook Formats. I've presented several Workshops at VAVF Conferences and try to attend every year. Our Conferences are never boring and there is always something new to learn — new techniques, new equipment, and new rules/format. I'm happy to be a member of this great group and to share in the changes that occur.

Janet Nullet

I have been a resident of St. Augustine, Florida, the Nation's Oldest City since 1989.

I was transplanted here to Florida from New York... I really have developed a southern accent as well as an appetite for southern foods as many of you may have noticed, that is because I am from the South Shore of Long Island.

I am a member and past president of Jacksonville's, Temple Sisterhood Braille Group.

I have enjoyed my membership and past conferences of VAVF where I have presented workshops the last few years.

I am looking forward to this year's conference in Orlando and meeting up with all y'all again.

This year, along with scanning with Omni, I am planning to go over hints and shortcuts using the scanned material in Microsoft Office 2007 and Braille2000 during my workshop.

I will welcome your suggestions and your input on the methods and hints you use and have found to be helpful.

Ruth Jean Ostle

Ruth Jean Ostle became a Floridian in 1967 when she and her family arrived in the Orlando area. Her two young children were both in school and husband Bernie was part of the new University, now called University of Central Florida. It was natural to wonder what visually impaired students would need at the public schools and at the University. Of course, they needed brailled texts, and in most cases, these were not available commercially. A radio announcement about classes in braille transcription seemed to offer a good answer to this problem, and it also led to many firm friendships with fellow transcribers. Since becoming certified in 1968, Ruth Jean has specialized in transcribing science texts and in creating various types of tactile graphics. She is a member of the Braille Association of Mid-Florida and a founding member of VAVF.

Leon Pettersen

Leon Pettersen is the owner and General Manager of WLVO-FM, a prominent FM radio station in Northern Florida and is highly regarded in national radio and television broadcasting. He is the President of VAVF. He is a long-time VAVF member and has been a member of Pinellas Braille Group, Inc. for many years. His specialty is the audio recording of text books, and he is highly regarded for his many popular teaching and expertise contributions, speech training, project organization and conference leadership for VAVF and the Pinellas Group in previous conferences.

Peg Rogaski

I'm Peg Rogaski and I'd like to tell you a little about myself. I became interested in becoming a Braille transcriber when my older son was a junior in high school. I was looking for something to help me avoid the dreaded "empty nest syndrome" when he left for college. I read about the Temple Sisterhood Braille Group in the local newspaper and decided to give it a try. It was the ideal volunteer activity for me — it was something new and challenging to learn, the people seemed nice, I could do the homework at home when it suited my schedule, and the group went out to lunch together on Thursdays — what more could a person want? I was certified in 1996 and became president of the group the next year. That led to my heading up VAVF with a lot of help from a lot of people and becoming involved in the planning of our annual conferences. There hasn't been a moment when the "empty nest syndrome" has even entered my mind!

My husband, Stan, is semi-retired so we're able to indulge in some great pastimes: football games — FSU and the Jacksonville Jaguars — and travelling. I'm writing this in Costa Rica while we're on a 33-day cruise around South America and Antarctica — life is very good at the moment! I can't wait to tell you all about it!

Dr. Robert Stepp

Robert Stepp, owner of Computer Applications Specialties Company, is the developer of Braille2000, now used by several thousand transcribers in the United States, Canada, Puerto Rico, and Hong Kong. He is pleased to report the recent hiring of a systems analyst assistant (currently in training) to help speed the development of new, advanced techniques for Braille2000 version 2, for handling NIMAS source files, table formatting, math, and tactile graphics. Some of the new technologies are being introduced in the beta release of versions 2, with more to follow.

Lynnette Taylor

I have been transcribing braille and teaching formatting for about 20 years. It has been a privilege to serve on various committees such as the BANA's Technical Formats Committee and to be a member and officer of VAVF for many years. I enjoy hearing from transcribers and trying to help them with the quirks textbook publishers can insert into a textbook.

Meg Wagner

A native of Charleston, W.Va., Meg became interested in braille through her friendship with Dee McCord, a fellow student at Emory University. Certified in Literary Braille since 1974, and in Nemeth since 1981, Meg is a past President of VAVF. She has served as VAVF's Braille2000 Consultant, and has given Braille2000 training sessions for volunteers around the state. She served on the Board of Directors of NBA, and is active in the Pinellas Braille Group, Inc. Meg and her husband, Linn, have three children and seven grandchildren.

Blanche Waller

I became a certified brailist in May 2009. I worked as a registered nurse for 30 years in various hospitals in Virginia and Florida. And while still working as a nurse, I went back to school and got a degree in Environmental Engineering. I currently work for the FL Dept. of Environmental Protection (DEP) as a professional engineer in the drinking water section. I'm already looking forward to retiring in a few years and will hopefully be able to afford to travel and see parts of the country that I have never seen.

Elliott Whitman

Elliott Whitman is a VAVF member working primarily with the Audio or Taping group. He did become Braille certified while serving as VAVF President so that he might work in concert with the Braille group. However, because he is seldom at a loss for words, he is most often found recording Audio text material for the VI students.

Elliott has been recording text material for FIMC for a number of years. He has used a variety of recording units during this period and has been confronted with a manifold number of procedures to use and problems to solve.

Mariann Witengier

I am a retired teacher of the visually impaired. I retired in 2004 after 38 years of teaching. I graduated from George Peabody College for Teachers (Vanderbilt University) where I majored

in education of the visually impaired and elementary education. I later received my masters from the FTU, now known as the University of Central Florida.

During the majority of my career I was involved in exceptional student education. The exception was two years in the late '60s when I taught pre-first and kindergarteners on the Zuni Reservation in New Mexico.

I have been an itinerant, self-contained and resource vision teacher as well as a teacher of the multiply handicapped. The majority of my career was spent at the middle school level working with children having physical, visual and multiple disabilities. I am currently working with afterschool and transition programs for school age children and young adults at Lighthouse Central Florida where I work on computer technology, activities of daily living, as well as academic tutoring, braille support and instruction using assistive technology (Dynavox).

As of March 2007, I fulfilled a life long goal of becoming a certified brailist. I am currently teaching the braille transcription course for our local association, the Braille Association of Mid-Florida, Inc., with the help of Jean Webber and Joyce Hull, long standing members of our organization.

HAWTHORN SUITES BY WINDHAM ORLANDO AIRPORT

VAVF LUNCHEON MENU

Monday, May 3, 2010
Noon

Entrées (Choose One)

1. Chicken Breast

(Sautéed in garlic and olive oil, green beans almandine and scalloped potatoes)

2. Eggplant Rollatini

(Eggplant layered with ricotta and mozzarella cheese, and tomato basil sauce, green beans almandine)

Salad and Rolls are included

Dessert

Chef's choice

Iced Tea or Water

Complimentary coffee is also available.

FOR THOSE STAYING IN THE HOTEL

FREE BUFFET BREAKFAST

and

2-hour complimentary Beer, Wine, Soup and Salad in the evening

served in the dining room

5 -7 pm

**We will once again have a hospitality room in the evenings outside the meeting rooms —
bring drinks and snacks to share there.**

ROOM RESERVATION

For
VISUAL AID VOLUNTEERS OF FLORIDA
ANNUAL CONFERENCE
May 3-5, 2010

HAWTHORN SUITES BY WINDHAM
7450 AUGUSTA NATIONAL DRIVE
ORLANDO, FL 32822
Phone: 407-438-2121 or 866-878-4175
Fax: 407-438-2275

\$99.00 for two Queens or \$95 for a King per night

Please call Hawthorn Suites at **1-866-878-4175** to make your reservation stating you are with VAVF. Then one person from each room will send Arlene Jensen (**6425 Streamport Dr., Orlando, FL 32822-3066**) a check made payable to VAVF for \$99/\$95 per night. VAVF will pay the hotel for all rooms for which we have been paid. Please make sure to send your check (luncheon and Conference fees may be included in the check) to Arlene before April 18, 2010, the cutoff date at the **Hawthorn** for our special \$99/\$95 rate. Any reservations made after this date will be at their market price on the day the reservation is made, plus 12.5% tax.

In order to receive these preferred rates, indicate that you are attending the VAVF Conference. Rate is effective for 3 days before and after the conference.

Hotel Features:

Free Full Buffet Breakfast

2 hours of complimentary Soup, Salad and Beer or Wine in the evening
Swimming Pool, Fitness room, Free Wireless Internet, Free Local Phone Calls
Refrigerator and Microwave in Every Room

Reservations must be received by April 18, 2010

Number of rooms: _____ Date of arrival: _____

Number of guests in room: _____ Approx. time of arrival: _____

Number of nights: _____ Date of departure: _____

1 King-sized Bed: _____ or 2 Queen Beds: _____

Name: _____

Address: _____

City: _____ State: _____ Zip: _____ - _____

Phone: _____ Fax: _____ E-mail: _____

Signature: _____ Date: _____

CONFERENCE REGISTRATION FORM

“Dedication Makes the Difference”

Name: _____

Address: _____

City: _____ State: _____ Zip: _____ - _____

E-mail: _____ Phone: _____

Please include your email address and phone number in case we have questions about your registration, etc. It's very important that we can get in touch with you promptly.

Please specify your title and organization if you would like to have them on your nametag.

Title: _____ Organization: _____

Registration:

_____ Member/Associate Member (\$30.00) postmarked BEFORE 04/18/10 _____

_____ Member/Associate Member (\$40.00) postmarked AFTER 04/18/10 _____

_____ Non-Member (\$50.00) postmarked BEFORE 04/18/10 _____

_____ Non-Member (\$60.00) postmarked AFTER 04/18/10 _____

_____ One-Day Non-Member/Never Attended OR Spouse
and/or Companion (\$15.00) _____

_____ VAVF Luncheon (\$21.00) _____

_____ Hotel Fees [\$99.00 (2 queens) or \$95.00 (1 king) per night] _____

TOTAL CONFERENCE FEES (*Make checks payable to: VAVF, Inc.*) _____

Mail registration form, session preference form, and check to:

VAVF, Inc.

c/o Arlene Jensen

6425 Streamport Dr.,

Orlando, FL 32822-3066

HOTEL RESERVATION INFORMATION

The following information is important for VAVF. It will give us information we need to confirm the number of rooms reserved in the VAVF block. Please be sure to mention VISUAL AID VOLUNTEERS OF FLORIDA (VAVF) CONFERENCE when making your reservation.

_____ I am reserving a room in my name for _____ nights.

_____ I will be sharing a room reserved under another name for _____ nights.

_____ I will not be staying at the hotel.

LUNCHEON CHOICES AND SESSION PREFERENCE FORM

Name: _____

Address: _____

E-mail: _____ Phone: _____

I Need Workshop Materials in Braille: _____ in Large Print: _____.

I am a(n) Volunteer: _____ Educator: _____ Administrator: _____ Other: _____.

LUNCHEON CHOICES (CHOOSE ONE)

- _____ 1 Chicken Breast
 _____ 2 Eggplant Rollatini

SESSION PREFERENCES

*Check both sides of this form. Sessions go from #101-#305.
 Handouts will go first to those who signed up for that session by April 18, 2010!*

MONDAY, May 3, 2010

- _____ 101 Basic Nemeth
 _____ 102-A Braille2000 Version 2
 _____ 103 Groping for Graphics

 _____ 104 Advanced Nemeth
 _____ 102-B Braille2000 Version 2 (cont.)
 _____ 105 Graphic Analysis

 _____ **106 VAVF Luncheon**

 _____ 107 Scanning with Omni 16
 _____ 108 Basic Formats
 _____ 109-A Creating Foil Graphics

 _____ 110 Artistic Translation
 _____ 111 Braille2000 Options
 _____ 109-B Creating Foil Graphics (cont.)

TUESDAY, May 4, 2010

- _____ 201 Basic Braille2000
 _____ 202 Microsoft Office 2007: Word & Excel Basic
 _____ 203-A Hold that Tiger
- _____ 204 Proofreading Challenge
 _____ 205 Microsoft Office 2007: Word & Excel Intermediate
 _____ 203-B Hold that Tiger (cont.)

Lunch On Your Own

- _____ 206 Literary Challenge: The Game Show
 _____ 207-A Meet Your Readers
 _____ 208 Computer Braille Code
- _____ 209 Manuscript
 _____ 207-B Meet Your Readers (cont.)
 _____ 210 Nemeth Uniform Braille System (NUBS)

WEDNESDAY, May 5, 2010

- _____ 301-A Formats Challenge
 _____ 302 Classroom Worksheets & Tests
 _____ 303 Mentoring
- _____ 301-B Formats Challenge (cont.)
 _____ 304 Foreign Language Rules
 _____ 305 Literary Nemeth

Conference Over**VOLUNTEER-TO-HELP FORM**

The **Registration Table** needs volunteers to hand out name tags, etc. to our attendees. When can you help us out?

Monday: 7:30-8:30 _____ 8:30-10:00 _____ 10:00-10:30 _____ 10:30-12:00 _____
 2:00-3:30 _____ 3:30-4:00 _____ 4:00-5:30 _____

Tuesday: 7:30-8:30 _____ 8:30-10:00 _____ 10:00-10:30 _____ 10:30-12:00 _____
 2:00-3:30 _____ 3:30-4:00 _____ 4:00-5:30 _____

Wednesday: 7:30-8:30 _____

CONTRIBUTION (Memorial Scholarship Fund)

Name: _____
 Address: _____
 City/State/Zip: _____
 Amount: \$ _____ payable to VAVF, Inc. In memory/honor of: _____

Send to: VAVF, Inc., c/o Arlene Jensen, Treasurer, 6425 Streamport Dr., Orlando, FL 32822-3066

If there is a special occasion, such as a birthday or anniversary, or if the contribution is in memory/honor of, please fill in the information below and a card will be sent to the family of/honoree with your brief message.

Name: _____
 Address: _____
 City/State/Zip: _____
 Occasion/Brief Message: _____

MEMBERSHIP APPLICATION OR RENEWAL

Membership in VAVF is based on the calendar year--January-December. If you wish to join the statewide organization, please fill in the categories shown below on the membership application form and send it to

VAVF, Inc., c/o Arlene Jensen, Treasurer, 6425 Streamport Dr., Orlando, FL 32822-3066

Name: _____
 Address: _____
 City/State/Zip: _____
 E-mail: _____ Phone: _____

My specialties are: (*Certification Year or* \checkmark *if working in but not certified in:* _____)
 BRAILLE: Literary: _____ Textbook: _____ Translation Typing: _____
 Nemeth: _____ Music: _____ Foreign Language: _____
 RECORDING: _____
 GRAPHICS: _____
 LARGE TYPE: _____
 OTHER: _____

I need: braille _____ large print _____.

FEES: \$15.00 Regular Membership _____
 \$20.00 Booster Membership _____
 \$5.00 Associate Membership (spouse or other family members who accompany
 braillists/digital recorders/other media users to conferences) _____
 \$150.00 Lifetime Membership (may be paid in installments over 3 years) _____

Indicate total amount paid: \$ _____ payable to VAVF, Inc.