

COME JOIN US
At
THE 34th ANNUAL
FLORIDA CONFERENCE OF VOLUNTEERS
SERVING THE VISUALLY IMPAIRED
April 20-22, 2009

VISUAL AID VOLUNTEERS OF FLORIDA, INC.
“Dedication Makes the Difference”

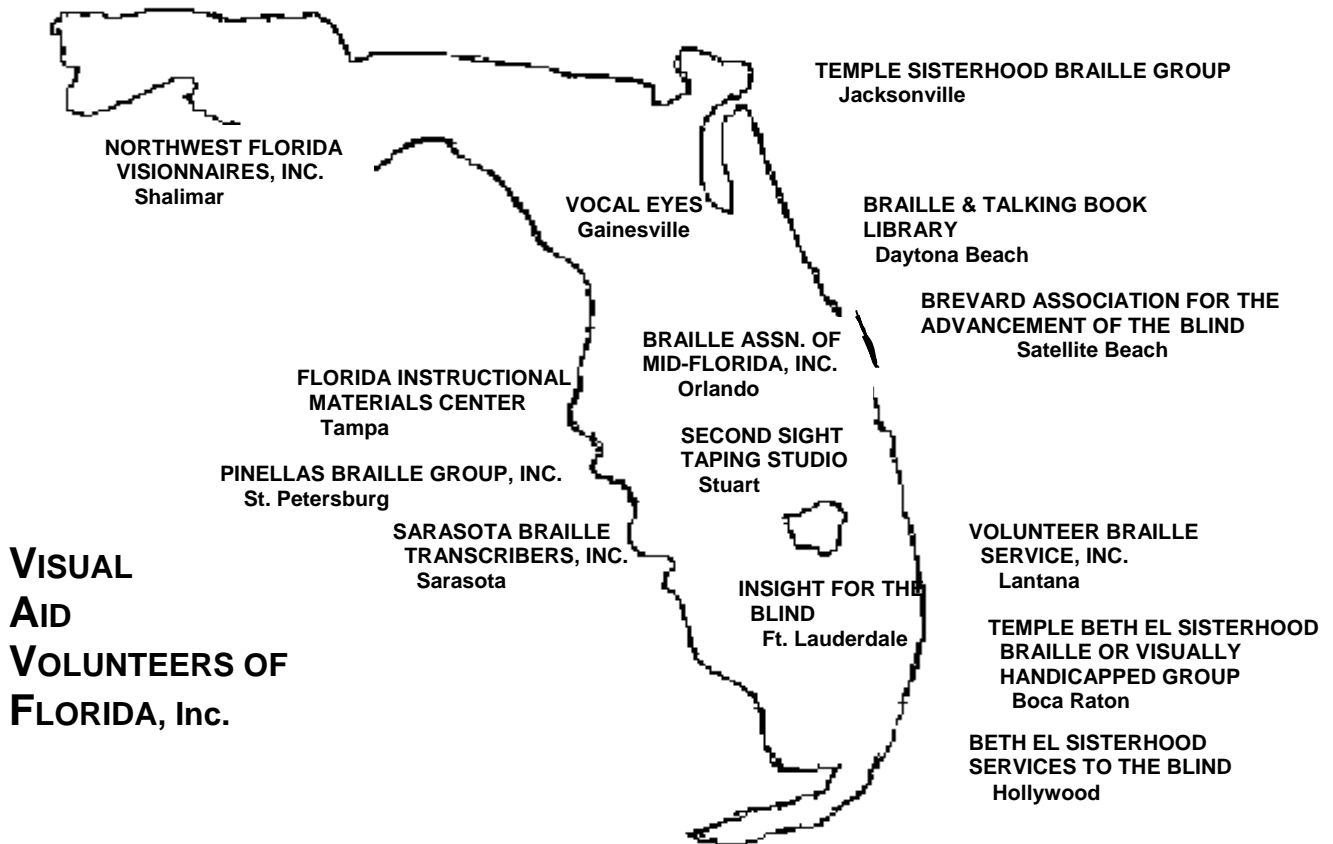

**VISUAL
Aid
VOLUNTEERS OF
FLORIDA, Inc.**

HAWTHORN SUITES
7450 AUGUSTA NATIONAL DRIVE
ORLANDO, FL 32822
Phone: 407-438-2121 or 866-878-4175
Fax: 407-438-2275

APH:

American Printing House for the Blind

BANA:

Braille Authority of North America

CASC:

Computer Applications Specialties Company, Inc. (Dr. Robert Stepp)

CVI:

Center for the Visually Impaired

FIMC:

Florida Instructional Materials Center

NBA:

National Braille Association, Inc.

NIMAS:

National Instructional Materials Accessibility Standards

VAVF:

Visual Aid Volunteers of Florida, Inc.

VAVF 2009 CONFERENCE ANOTHER MEMORABLE YEAR!!!

Conference time again! We will be back at the Hawthorn Suites Orlando Airport from April 20-22nd. We are looking forward to seeing you all again. Do encourage some new people to join us.

We are excited about the program. Many of our reliable presenters are back and some new ones will be there also. Dr. Robert Stepp will bring us up to date with Braille2000 version 2, which will be able to handle NIMAS files. As you know NIMAS files are the way we are going to receive new books in the future. Bob is working very hard to provide us with the tools to make life easier. It will also make us more efficient. Lynnette Taylor is going to deal with handouts from electronic sources. Susie Coleman is going to show us how to have fun with computer graphics. A new feature this year that we are trying out due to demand is; we are repeating two different workshops. Lynnette's *Handouts* and Susie's *Computer Graphics* are going to be in two time slots.

Ruth Jean Ostle is really going to be working hard this year. She is presenting a collage and a graphics analysis workshop. Janet Nullet will be showing new scanning tricks and telling new jokes. Florence Mathiesen will discuss multilanguage glossaries. Joanne Baldwin will talk about lower grades math. I will show how to trace maps in Word.

Ronee Hudson, Ben Fischer and Dan Pekich will tell us about music technology. Doug Hall and Ronee will talk about daily living as a blind person.

Our new presenters will be Juanita Jones from FIMC, who will point out the common errors found at FIMC. Brenda Berry will chair a panel discussion on volunteer group recruitment. Dan Pekich and Ben Fischer will also show us how to organize our files on computer.

For the student braillists, Linda Jacobson will host two panel discussions on the trial manuscript and proofreading. Dr. Robert Stepp and Meg Wagner will show the new version of Braille2000 to students and certified braillists. Lynnette's literary oddities are also intended for both students and certified braillists.

We are going to have the same arrangement for booking rooms this year as last year. Arlene Jensen has kindly offered again to do the extra work to save us the tax. We are to call the hotel at 1-866-878-4175 and make our reservation saying we are with VAVF then one person from each room will send Arlene (6425 Streamport Dr., Orlando, FL, 32822) a check made payable to VAVF for \$99 per night. VAVF will pay the hotel for all rooms on the master list. Please make sure to send your check to Arlene before April 6, 2009, the cutoff date at the Hawthorn, for our special \$99 rate. Any reservations made after this date will be at their regular price, plus 12.5% tax. When we are making the reservation, we will have to give a credit card number. All hotels (all over the world) require a credit card number, even though the basic room charge of \$99 is paid by a master account (VAVF in this case), the card would cover any additional charges to the room which the occupant is responsible for.

Come and join us for an exciting 2009 VAVF Conference. Remember:

1. Make your hotel reservation NOW and send the check to Arlene Jensen before 04/06/08 to be included on the master list. (Latecomers will have to pay market rates + tax).
2. Be sure to sign up for the VAVF luncheon

3. Send in Conference registration with a check, for Conference, luncheon AND hotel NOW. (One check can cover all the fees and room costs).
4. Even if you wish to book and pay for the rooms yourself, please tell the Hotel you are part of VAVF because we only get this great room rate if a certain number of rooms are occupied.

You'll be glad you booked.

Pat Gray

Here is a map of the second floor where the Meeting Rooms are. There is elevator access to the upper floors

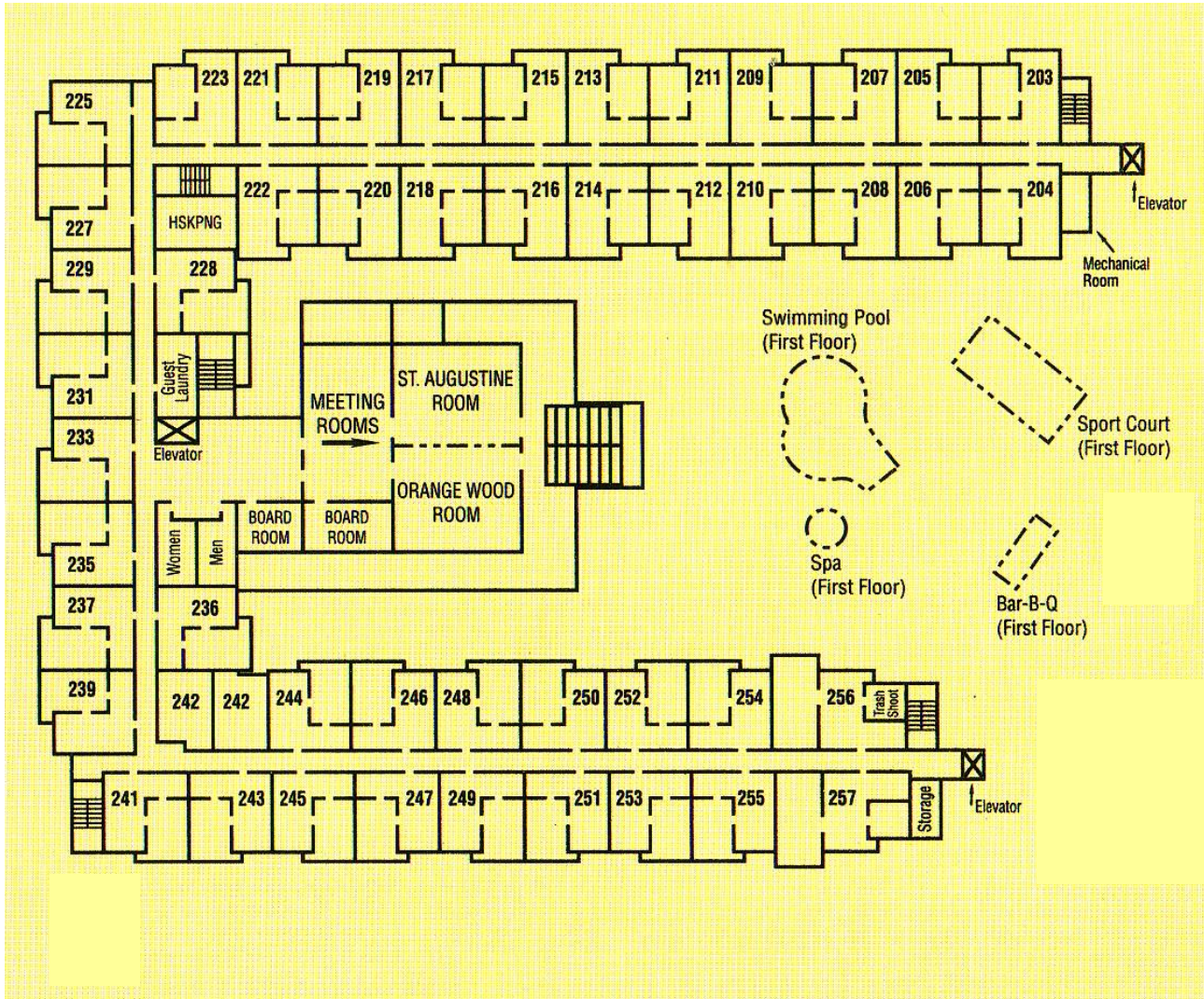

The dining room is on the first floor under the meeting rooms. Complimentary coffee is available there 24 hours. The store is behind the hotel registration desk.

Directions to the Orlando Airport Hawthorn Suites

7450 Augusta National Drive
Orlando, FL 32822
Tel: (407) 438-2121
Fax: (407) 438-2275

From I-95:

Take exit 260B to merge onto I-4 W toward Orlando. Take exit 101AB toward Sanford/Int'l Airports. Merge onto Central Florida Greenway/ SR 417 South bound (101 B). SR 417 is a toll way. Take exit 26 for SR 528-TOLL-WEST toward Int'l Airport, merge onto SR 528 West bound. SR 528 west or the Beachline (old Beeline) is a toll way. Take the exit 11A to merge onto S Semoran Blvd/SR 436 North bound. **Do not take the airport exit.** Travel North on Semoran Blvd/SR 436 N less than a 1/4 of a mile to TG Lee Blvd and turn right at the light. There is a TGIF Restaurant on the left. Go to the stop sign and turn right on Augusta National Drive. The Hawthorn Suites is approximately 1/4 mile on your right across from the pond.

From the Airport by Car

Exit from airport on SR 436 North (Semoran Blvd). Travel North 1/4 of a mile to TG Lee Blvd and turn right at the light. There is a TGIF Restaurant on the left. Go to the stop sign and turn right on Augusta National Drive. The Hawthorn Suites is approximately 1/4 mile on your right across from the pond.

From Airport by Shuttle

There is a shuttle available from the hotel. Phone hotel at (407) 438-21213 to arrange pick-up.

From Florida Turnpike, Either Direction

Take Exit for Beachline (old Beeline) Expressway (528) going East bound. The Beachline is a toll way. Travel East on the Beachline to the exit for Semoran Blvd (SR 436) and go North on Semoran Blvd. Travel North on Semoran Blvd less than a 1/4 of a mile to TG Lee Blvd and turn right at the light. There is a TGIF Restaurant on the left. Go to the stop sign and turn right on Augusta National Drive. The Hawthorn Suites is approximately 1/4 mile on your right across from the pond.

From Interstate 4

Coming into town from the West (Tampa area), Exit on to the Beachline (old Beeline) Expressway heading East. The Beachline is a toll way. If coming into town from the North/East, take the Florida Turnpike exit and go South. From the Florida Turnpike, take the Beachline Expressway exit and go East. Stay on the Beachline heading towards the airport. Take the exit for Semoran Blvd (SR 436) North bound. **Do not take the airport exit.** Travel North on Semoran Blvd less than a 1/4 of a mile to TG Lee Blvd and turn right at the light. There is a TGIF Restaurant on the left. Go to the stop sign and turn right on Augusta National Drive. The Hawthorn Suites is approximately 1/4 mile on your right across from the pond.



Hotel Location

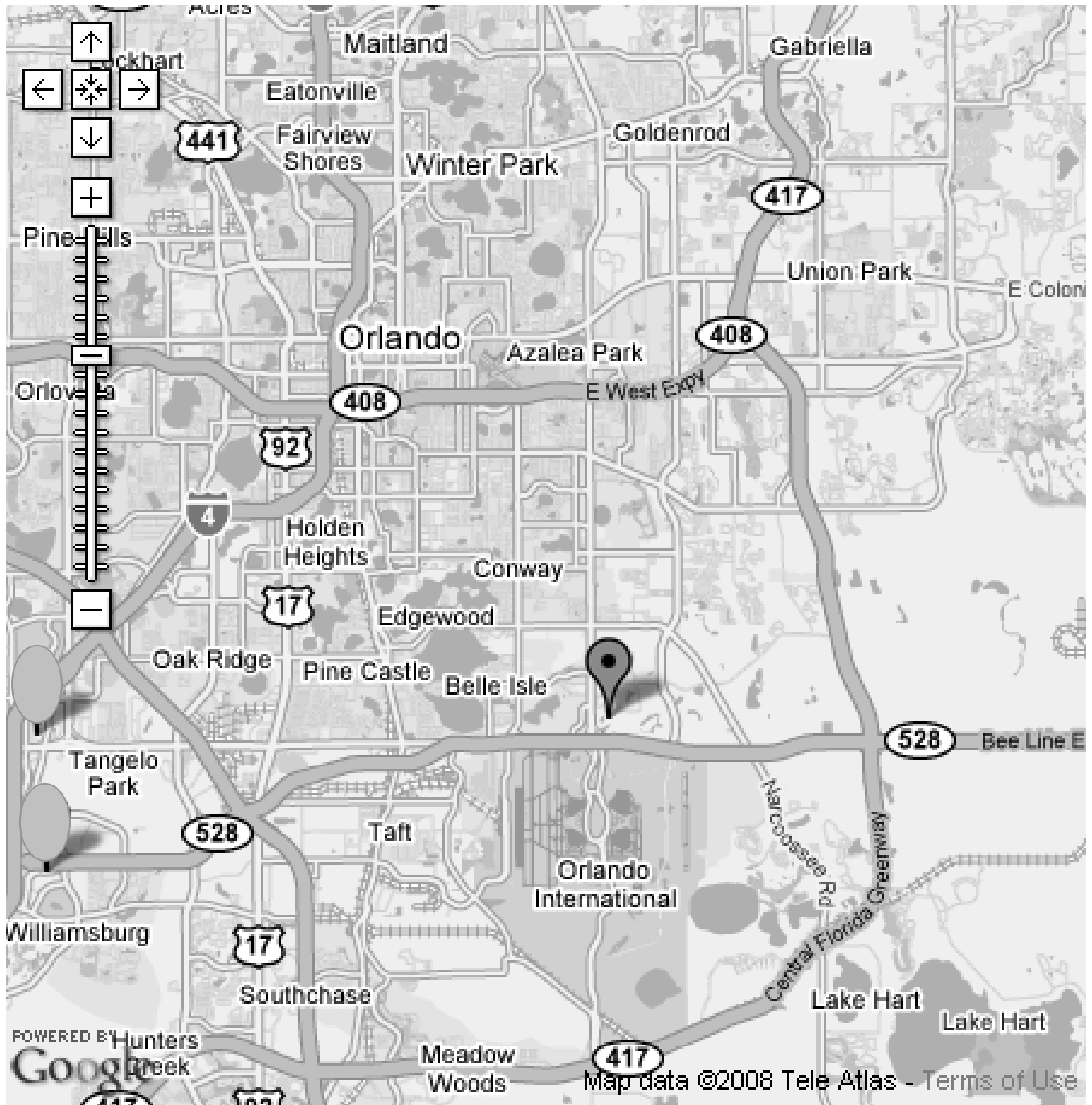

WORKSHOP DESCRIPTIONS

MONDAY, April 20, 2009

Please note that sessions are different lengths of time. Some are three hours long while others are for a shorter time. Longer sessions are in two parts, identified by A and B.

Time	Session and Description
8:30-10:00 AM	<p>Session 101-A: Creating Collages [Room A] Ruth Jean Ostle Hands-on: for making maps and other graphics accurately and easily.</p> <p>Session 102-A: Handouts from Alternate Sources [Room B] Lynnette Taylor A sampling of electronic handouts and how to prepare braille transcriptions. Includes PowerPoint, Excel, and PDF files. Bring any questions or examples you wish to discuss.</p> <p>Session 103: BRL2000 for Beginners [Room C] Meg Wagner & Robert Stepp There are five sessions on Braille2000 (for beginners, NIMAS and RTF introduction (double-length session), NIMAS and RTF hands-on (double-length session)). This workshop will introduce Braille2000 Version 2 and explain how it is used for direct entry braille. If you have experience with Braille2000 you can attend the other Braille2000 workshops without attending this one.</p>
10:00-10:30 AM	BREAK
10:30-12:00	<p>Session 101-B: Creating Collages (continued) [Room A] Ruth Jean Ostle</p> <p>Session 102-B: Handouts from Alternate Sources (continued) [Room B] Lynnette Taylor</p> <p>Session 104: The Trial Manuscript [Room C] Linda Jacobson There will be a panel to share their experiences. A student just learning braille rules, a newly certified transcriber, someone who has just completed the course working on their trial manuscript and an experienced transcriber.</p>
12:00-2:00 PM	Session 105: LUNCHEON and INSTALLATION OF OFFICERS

2:00-3:30 PM

Session 106-A: BRL2000 Version 2 Overview

[Room A] *Dr. Robert Stepp & Meg Wagner*

There are five sessions on Braille2000 (for beginners, NIMAS and RTF introduction (double-length session), NIMAS and RTF hands-on (double-length session)). This workshop will introduce new techniques for handling RTF and NIMAS source files. You are encouraged to attend the subsequent sessions for hands-on experience.

Session 107: Lower Grades Math

[Room B] *Joanne Baldwin*

This workshop will discuss items commonly found in math books for grades 1-3 and the adaptations that need to be made in the braille edition. Participants are welcome to bring examples.

Session 108: Literary Oddities

[Room C] *Lynnette Taylor*

We will discuss things you didn't learn in your transcribing course. Examples of diaries, lists, displayed material and other types of text not covered in the Manual will be shown and the proper formatting discussed. Bring any questions or examples you wish to discuss.

3:30-4:00 PM

BREAK

4:00-5:30 PM

Session 106-B: BRL2000 Version 2 Overview (continued)

[Room A] *Dr. Robert Stepp & Meg Wagner*

Session 109: Common Errors found at FIMC

[Room B] *Juanita Jones*

Common errors found at FIMC: ways we can eliminate those errors, and how "we" working together can get our books to the Visually Impaired students in a timely manner.

Session 110: Proofreading

[Room C] *Linda Jacobson*

How do people proofread? What works for you? We will have a panel to share their proofreading techniques. We will also do some proofreading.

TUESDAY, APRIL 21, 2009

Please note that sessions are different lengths of time. Some are three hours long while others are for a shorter time. Longer sessions are in two parts, identified by A and B.

Time	Session and Description
8:30-10:00 AM	<p>Session 201-A: BRL2000 Version 2; Hands-on [Room A] <i>Dr. Robert Stepp and Meg Wagner</i> There are five sessions on Braille2000 (for beginners, NIMAS and RTF introduction (double-length session), NIMAS and RTF hands-on (double-length session)). This workshop will give you hands-on practice using some of the concepts you learned in the introductory workshop. You are encouraged to attend the previous sessions for an introduction to the new concepts. Those without a computer will be seated next to someone with a computer.</p>
	<p>Session 202-A: Fun with Computer Graphics; Hands On [Room B] <i>Susie Coleman</i> Come have fun drawing computer illustrations using Microsoft Word's Draw function. We will work with shapes, lines, "textures", copying and pasting, moving, saving, edit points, etc. These computer braille graphics use the TIE (Tactile Image Enhancer) or may be cut out as a pattern for collage or foil. Bring your laptop and join in the fun.</p>
	<p>Session 203: Independent Living Without Looking; How Do You Do It? [Room C] <i>Doug Hall & Ronee Hudson</i> How does a person who is blind or visually impaired know how to perform basic personal tasks and duties around the home? (money identification, telling time, needle threading and sewing, selecting and caring for clothes, paying bills, cleaning, meal preparation, etc.) Come share questions, ideas and tips with others.</p>
10:00-10:30 AM	BREAK
10:30-12:00	<p>Session 201-B: BRL2000 Version 2; Hands-on (continued) [Room A] <i>Dr. Robert Stepp and Meg Wagner</i></p>
	<p>Session 202-B: Fun with Computer Graphics; Hands-on (continued) [Room B] <i>Susie Coleman</i></p>
	<p>Session 204: Technology for Blackboard Training & Music Software [Room C] <i>Ronee Hudson, Ben Fischer & Ben Pekich</i> CVI staff will present information on the use of Blackboard for visually impaired students. The Center's blind teens have been using this software to access on-line classes at the agency. This will enable them to prepare for college on-line training. We will also demonstrate the use of musical software for blind musicians used in our Transition Program.</p>

- 12:00-2:00 PM** **LUNCH ON YOUR OWN**
- 2:00-3:30 PM** **Session 205: Graphic Analysis**
[Room A] Ruth Jean Ostle
 Discussion of actual textbook illustrations and what to do with them.
 Attendees are encouraged to bring any examples that may contain problems.
- Session 206: Organizing Files**
[Room B] Ben Fischer & Dan Pekich
 Instructors from the Center for the Visually Impaired, Inc. in Daytona Beach will demonstrate and discuss different options and methods for people to use in organizing and naming computer files at work or home. This presentation will be a demonstration and attendees are encouraged to come ready and armed with their own ideas to exchange.
- Session 207-A: Handouts from Alternate Sources (Repeat)**
[Room C] Lynnette Taylor
 Repeat of Monday's workshop.
- 3:30-4:00 PM** **BREAK**
- 4:00-5:30 PM** **Session 208: How to Trace Maps in Word**
[Room A] Pat Gray
 This workshop will be a demonstration of tracing maps in Word on a computer.
- Session 209: Volunteer Group Management**
[Room B] Brenda Berry
 Keys for successful recruiting and retainment of new members. Receiving and returning FIMC materials. Share information on what works for your organization. Discuss problems that your organization may be experiencing.
- Session 207-B: Handouts from Alternate Sources (Repeat) (continued)**
[Room C] Lynnette Taylor
 Repeat of Monday's workshop.

WEDNESDAY, APRIL 22, 2009

***Please note that sessions are different lengths of time.
Some are three hours long while others are for a shorter time.
Longer sessions are in two parts, identified by A and B.***

Time	Session and Description
8:30-10:00 AM	<p>Session 301-A: Fun with Computer Graphics; Hands On (Repeat) [Room A] <i>Susie Coleman</i> Repeat of Tuesday's workshop.</p> <p>Session 302: Multilanguage Glossaries; New Format Suggestions [Room B] <i>Florence Mathiesen</i> The workshop lecture will be based on a handout that will list format rules and demonstrate format for a variety of English/Spanish Glossary Formats. Also included for transcribers who use scanned material is a section on using the Windowize feature in Braille 2000.</p>
10:00-10:30 AM	BREAK
10:30-12:00 PM	<p>Session 301-B: Fun with Computer Graphics; Hands On (Repeat) (continued) [Room A] <i>Susie Coleman</i> Repeat of Tuesday's workshop.</p> <p>Session 303: Scanning for Beginners [Room B] <i>Janet Nullet</i> Will introduce the method of scanning using Omni Page Pro, Microsoft Word and Braille2000. Janet requests that attendees would e-mail her with any questions or problems that they would like to have covered during the workshop. Her e-mail address is jan4sunfun@aol.com.</p>

CONFERENCE OVER

		<i>Time</i>	<i>Room A</i>	<i>Room B</i>	<i>Room C</i>
		MONDAY	April 20, 2009	8:30--10:00	101-A: Creating Collages Ruth Jean Ostle
10:00--10:30	BREAK				
10:30--12:00	101-B: Creating Collages Ruth Jean Ostle			102-B: Handouts from Alternate Sources (continued) Lynnette Taylor	104: The Trial Manuscript Linda Jacobson
12:00--2:00	105: LUNCHEON and INSTALLATION OF OFFICERS				
2:00--3:30	106-A: BRL2000 Version 2: Overview Meg Wagner & Dr. Robert Stepp			107: Lower Grades Math Joanne Baldwin	108: Literary Oddities Lynnette Taylor
3:30--4:00	BREAK				
4:00--5:30	106-B: BRL2000 Version 2: Overview (continued) Meg Wagner & Dr. Robert Stepp			109: Common Errors Found at FIMC Juanita Jones	110: Proofreading Linda Jacobson

		<i>Time</i>	<i>Room A</i>	<i>Room B</i>	<i>Room C</i>	
		TUESDAY	April 21, 2009	8:30--10:00	201-A: BRL2000 Version 2: Hands-on Dr. Robert Stepp & Meg Wagner	202-A: Fun with Computer Graphics Susie Coleman
10:00--10:30	BREAK					
10:30--12:00	201-B: BRL2000 Version 2: Hands-on (continued) Dr. Robert Stepp & Meg Wagner			202-B: Fun with Computer Graphics (continued) Susie Coleman	204: Technology for Blackboard Training & Music Software Ronee Hudson, Ben Fischer & Dan Pekich	
12:00--2:00	LUNCH ON YOUR OWN					
2:00--3:30	205: Graphics Analysis Ruth Jean Ostle			206: Organizing Files Ben Fischer & Dan Pekich	207-A: Handouts from Alternate Sources (Repeat) Lynnette Taylor	
3:30--4:00	BREAK					
4:00--5:30	208: How to Trace Maps in Word Pat Gray			209: Volunteer Group Management Brenda Berry	207-B: Handouts from Alternate Sources (Repeat) (continued) Lynnette Taylor	

		<i>Time</i>	<i>Room A</i>	<i>Room B</i>	<i>Room C</i>	
		WEDNESDAY	April 22, 2009	8:30--10:00	301-A: Fun with Computer Graphics (Repeat) Susie Coleman	302: Multilanguage Glossaries; New Format Suggestions Florence Mathiesen
10:00--10:30	BREAK					
10:30--12:00	301-B: Fun with Computer Graphics (Repeat) (cont.) Susie Coleman			303: Scanning for Beginners Janet Nullet	No workshop	
12:00--2:00	CONFERENCE OVER					
2:00--3:30						
3:30--4:00	BREAK					
4:00--5:30						

MEET OUR PRESENTERS

Joanne Baldwin

Joanne Baldwin was certified in Math Transcribing in 1983 and in Math Proofreading in 1995. She is currently one of the reviewers of lessons and tests for the NLS Math Transcribing Course.

Brenda Berry

I was born in Massachusetts, raised in Rhode Island. I married a Navy man and moved to Jacksonville, Florida in 1959. I have lived in the area ever since, except for two years in Maine and three years in Puerto Rico. I have two daughters and three grandchildren. My work and volunteer experience has been as diverse as my living arrangements.

Currently I live in St. Augustine and I am a graphic artist with the Temple Sisterhood Braille Group in Jacksonville. Janet Nullet peaked my curiosity. "The group needed people to do graphics, you know cut and paste". "The group went to lunch after the work was finished, they only met once a week and we could car-pool from St. Augustine". Well I went to Orientation Day with her to see what they were all about, and I liked what I saw because six conferences later, here I am.

I am proud to be a part of this group, their dedication and passion to be of service inspires me. I soon realized that doing graphics is a bit more than cut and paste, but I enjoy the work. Becoming a member of VAVF has afforded me the opportunity to meet so many amazing people, both in talent and spirit.

Our lunchtime discussions and our Temple potluck luncheons aren't too shabby either. We are still car-pooling, thanks Janet.

Susie Coleman

One of the worst things in the world to me would be not being able to read. So when I saw a newspaper article in the Jacksonville newspaper about the local braille group, I phoned one of the numbers and asked about the braille class. I was extremely shy (Yes, I was so!), but Bernita Gilberstadt talked me into coming to the first class. I've been learning ever since.

I've been certified in braille transcription since 1988 and involved with graphics within a year or two after that. Midge Dusenberry was, and still is, my teacher. I started out using one of the bulky gray plastic American Printing Press graphics kit (rubber pad, spur wheels, metal texture forms, etc.) and gradually added scraps of everything and anything that could be glued to paper. Ruth Jean Ostle's hands-on workshops have been so educational and inspirational. After one of Pete and Doris Schuyler's workshops, I added computer graphics as yet another way to produce braille illustrations. Anything that works is my motto.

Somehow I ended up as one of VAVF's past presidents in the 1990's as well as Jacksonville's Temple Sisterhood Braille Group's president in the late 1980's. Shook in my boots every meeting. Next year, I'll be president of TSBG again. I can handle it every 20 years or so as long as I can depend on such a great crew of members.

Ben Fischer

Ben Fischer has a Bachelor's in Music Theory from Heidelberg College in Ohio and has extensive experience in teaching, fundraising, and event planning. He has finished course work at the Lighthouse International in order to become a Vision Rehabilitation Therapist. In addition,

he is currently pursuing a certification in Orientation and Mobility. Ben has been employed as a Transition Teacher at the Center for the Visually Impaired since July of 2007 and leads the Art and Music Initiative.

Pat Gray

I was born and bred in Ireland, where I married my husband, Martin, and subsequently had two lovely children. Soon afterwards we decided to travel with work. So in 1983, my family and I moved to Libya first, then on to Abu Dhabi, Milan and finally settling in Jacksonville in 1999.

When I came first, I only had a resident's visa so couldn't work. I heard the Channel 12 request for Braille volunteers which immediately sparked my interest. I went to Orientation, attended the classes and became certified in 2003.

When I got my green card and was legally allowed to work, I was so busy doing Braille, I didn't have time to work in a paid job. When Thelma said you "have to dedicate a lot of time to Braille", I had no idea what I was letting myself into but I love doing braille! Being elected the VAVF president has been the icing on the cake and I hope to be a part of this group for many years more.

I found a map program on the internet a few years ago and sometimes still use it but increasingly have found that it is easier to trace the print copy. The ladies in our graphic group and I have done a lot of maps since 2006. They mostly do them by collage, I am always impressed by the beautiful work they do with all sorts of materials. As I do not have the patience for collage, I stick to the tool I prefer, the computer.

Doug Hall

Doug Hall has more than 50 years experience performing activities of daily living. He earned his Masters degree in Counseling and is a Senior Rehabilitation Specialist at Florida's Division of Blind Services Orientation and Adjustment Center in Daytona Beach, where he provides counseling and vocational services to students who are blind or visually impaired. He has facilitated classes in Life Skills, as well as Personal and Home Management for more than two years.

In addition to working at the Center, Doug serves on the Board of VAVF, the Board of the Florida Independent Living Council, is Chair of Daytona Beach's Mayor's Alliance for Persons with Disabilities, is a member of Volusia County's Elections Advisory Board, and is on the Board of Friends of Library Access, which assists Florida's Braille and Talking Book Library. He is a member of Halifax Council of the Blind, the local chapter of Florida Council of the Blind, and serves on the Board of FCB, where he chairs its Access Committee and is an active member of its Constitution and Bylaws, Public Education and Convention Committees. He is a member of the Greater Daytona Beach chapter of National Federation of the Blind of Florida.

Ronee Hudson

Ronee Hudson was born in New York City. She received her B.A. from Farleigh Dickinson University in New Jersey in 1975. Her M.A. degree in Rehabilitation of the Blind was received from the University of Arkansas in 1991. Since adjustment to blindness is an important component of the Center for the Visually Impaired program, Ms. Hudson returned to school at the University of Sarasota in 2002 and completed coursework leading towards licensure as a

mental health counselor. She is currently preparing for the examination to become licensed in the State of Florida. Ms. Hudson's commitment to vision rehabilitation is deeply rooted. She was drawn to the field of blindness rehabilitation as a result of her own congenital visual impairment. Ms. Hudson is an active member of several consumer groups that advocate for persons with visual impairment such as, National Federation of the Blind, Florida Council of the Blind, Friends of Library Access, Inc. and Visual Aid Volunteers of Florida.

Ronee's Master's degree in Orientation and Mobility enabled her to begin the Orientation and Mobility program at the Center for the Visually Impaired in 1992. In 2000, she became the Executive Director of the agency which was a small agency with one office, three staff members and a \$300,000 budget. Eight years later, the agency now employs over 20 employees with a 1.4 million dollar budget. In addition there are two satellite offices serving Brevard County and West Volusia.

Ronee considers horseback riding to be her passion. She owns a gaited Paso Fino horse named, "*Poncho*" and is training him in *Dressage*. Ronee is also interested and concerned about environmental issues. She is actively pursuing ways that the Center for the Visually Impaired can operate their offices in an environmentally friendly manner. She also enjoys reading, yoga and exercising.

Ronee Hudson is Director of the Center for the Visually Impaired. Ronee is a graduate of the University of Arkansas and holds a Masters Degree in Rehabilitation of the Blind with an emphasis in Orientation and Mobility. She worked at the Center for the Visually Impaired as a Teacher for 13 years before taking the position of Executive Director in 2000. Since taking the position she has worked diligently to expand services in four counties, Volusia, Flagler, Putnam and Brevard. In 2006, The Center for the Visually Impaired received a grant from Microsoft Corporation and opened a state of the art Technology Center for Blind individuals. This year the agency received a grant to establish a music and art program for blind teens. Other projects this year include the establishment of a Sensory Garden and a Low Vision Clinic.

Ronee is married and has two children who reside in Florida. Her husband is Edward Hudson who is the Director of the State of Florida Orientation & Adjustment Center in Daytona Beach.

Linda Jacobson

I have been using braille for over 40 years and have come to rely on it for many reasons. I use it to read recipes, addresses and phone numbers, to play games, to read novels, etc. Mostly though, I use it in my work as a braille proofreader.

I serve as a consultant on the BANA (Braille Authority of North America) literary committee. I evaluate trial manuscripts for NLS (National Library Service) certification. I am also an instructor for the NLS proofreading and literary correspondence courses. I enjoy my work and of course I enjoy braille.

Juanita Jones

I am a current resident of Odessa, Florida. I lived in Tampa, Florida until I moved to Odessa, Florida, where I have resided since 1987. I am currently employed with Hillsborough County Schools, at the Florida Instructional Materials Center f/t Visually Impaired, Tampa Florida, where I work as a Braille Transcriber and the Assignment Chairperson for the materials (books, etc.) that our volunteers receive. Part of my job is to check the volumes as they are received from our volunteers.

I was first introduced to Braille when I began working at FIMC in the Braille production department, where I embossed Braille books. The Braille was (and still is) so fascinating to me until I started to learn some of it on my own.

After taking lessons and instructions from Jan Kirby in 2002, I became a Certified Braille Transcriber in 2003. Then I wondered why I waited so long. I enjoy Braille, but my full time job at FIMC does not permit me to Braille as much as I would like.

This is my first workshop presentation and I am happy to be a part of the 2009 VAVF Conference.

Florence Mathiesen

1979-1989: I became a self-taught Braille Transcriber in Anchorage, Alaska where I worked as a Teacher Assistant in the Blind/Visually Impaired Program. I earned my Literary Certificate from the Library of Congress in 1987.

Upon retirement my husband and I and our two cats traveled in the United States and Canada in our motor-home for two years.

In late 1991 we bought a home and settled down in Crestview, Florida. When my computer came out of storage in working order in 1992, I made contact with the Northwest Florida Visionnaires Braille Group in Shalimar, Florida: That year I joined both the Visionnaires and VAVF. Since then I've kept busy transcribing textbooks for FIMC. I am a past president of VAVF, and currently serve as a Board Member and as a VAVF Skills Consultant. I have led several Glossary/Dictionary Workshops at past VAVF Conferences and in 2006 earned my National Braille Association (NBA) Certificate in Braille Textbook Formatting.

We still travel by motor-home (with two different cats) every chance we get.

Janet Nullet

I have been a resident of St. Augustine, Florida, the Nation's Oldest City since 1989. I was transplanted here to Florida from New York ... I really have developed a southern accent as well as an appetite for southern foods as many of you may have noticed, that is because I am from the South Shore of Long Island.

I am a member and past president of the Jacksonville Temple Sisterhood Braille Group.

I have enjoyed my membership and past conferences of VAVF where I have presented workshops the last few years.

I am looking forward to this year's conference in Orlando and meeting up with all y'all again.

This year I will be planning my workshop for beginners to introduce some new people to all the advantages scanning has to offer to braillists.

Ruth Jean Ostle

Ruth Jean Ostle ventured into Florida and the Orlando area more than 40 years ago, and soon found friends and a passion for the world of braille transcribing. She is a long-time member of the Braille Association of Mid-Florida and VAVF, and has been a certified transcriber since 1968. Her family teases that by now, she thinks in braille and she can never get lost because her fingerprints are etched, through excess use, on the keys of both her Perkins and computer. Although she prefers transcribing biology texts, she has experience creating the necessary graphic illustrations commonly found in many textbooks. One of the great advantages of this association is that there is always something new and important to learn. A major object of the

graphics workshops offered at the VAVF Conference is sharing experiences and learning from each other.

Dan Pekich

Dan Pekich has a Master's Degree in Health Science from the University of Florida . He is a Certified Rehabilitation Counselor and a Registered Mental Health Counselor Intern. Dan's previous experience includes working with people with substance abuse issues, schizophrenia, stroke, and developmental disabilities. He also has extensive experience in research theory and practice. Since December of 2006, Dan is the Program Manager for the Center for the Visually Impaired's Teenage Transition Program.

Dr. Robert Stepp

Robert Stepp founded Computer Applications Specialties Company in 1995, shortly after developing ED-IT PC (which was inspired by his earlier braille editing tool "ED-IT" for the Apple II). Work continues on developing Braille2000 V2, with tools for NIMAS source files, for use by transcribers, teachers and parents, and visually impaired braille authors and transcribers.

Lynnette Taylor

I have been transcribing braille and teaching formatting for about 20 years. It has been a privilege to serve on various committees such as the BANA's Technical Formats Committee and to be a member and officer of VAVF for many years. I enjoy hearing from transcribers and trying to help them with the quirks textbook publishers can insert into a textbook.

Meg Wagner

Meg Wagner is a native of Charleston, W.Va., and became interested in braille through her friendship with Dee McCord, a fellow student at Emory University. Certified in Literary Braille since 1974, and in Nemeth since 1981, Meg is currently Immediate Past President of VAVF. She has served as VAVF's Braille2000 and ED-IT PC Consultant, and has given Braille2000 training sessions for volunteers around the state. She served on the Board of Directors of NBA, and is active in the Pinellas Braille Group, Inc. Meg and her husband, Linn, have three children and seven grandchildren.

ORLANDO AIRPORT HAWTHORN SUITES

VAVF LUNCHEON MENU

Monday, April 20, 2009

Noon

Entrées (Choose One)

1. Chicken Marsala

(with rice pilaf and seasonal vegetables;)

2. Vegetarian Baked Pasta

(Penne pasta in a marinara sauce with mushrooms, herbs, gorgonzola and mozzarella cheeses.
It is also served with seasonal vegetables.)

Salad and Rolls are included

Dessert

Chef's choice

Iced Tea or Water

Complimentary coffee is also available.

**FOR THOSE STAYING IN THE HOTEL
FREE BUFFET BREAKFAST**

and

**2 hour complimentary beer, wine, soup and salad in the
evening**

both served in the diningroom

5-7 pm

**We will once again have a hospitality room in the evenings outside the
meeting rooms--**

bring drinks and snacks to share there.

ROOM RESERVATION

For

VISUAL AID VOLUNTEERS OF FLORIDA
ANNUAL CONFERENCE

April 20-22, 2009

HAWTHORN SUITES

7450 AUGUSTA NATIONAL DRIVE

ORLANDO, FL 32822

Phone: 407-438-2121 or 866-878-4175

Fax: 407-438-2275

\$99.00 Single, Double, Triple, or Quad Occupancy per night

(Please call Hawthorn Suites at **1-866-878-4175** to make your reservation stating you are with VAVF. Then one person from each room will send Arlene Jensen (**6425 Streamport Dr., Orlando, FL, 32822-3066**) a check made payable to VAVF for \$99 per night. VAVF will pay the hotel for all rooms for which we have been paid. Please make sure to send your check (luncheon and Conference fees may be included in the check) to Arlene before April 06, 2009, the cutoff date at **Hawthorn** for our special \$99 rate. Any reservations made after this date will be at their market price on the day the reservation is made, plus 12.5% tax.)

In order to receive these preferred rates, indicate that you are attending the VAVF Conference.
Rate effective for 3 days before and after conference.

Hotel Features:

Free Full Buffet Breakfast

2 hours of complimentary Soup, Salad and Beer or Wine in the evening
Swimming Pool, Fitness room, Free Wireless Internet, Free Local Phone Calls

Refrigerator and Microwave in Every Room

Reservations must be received by April 6, 2009

Number of rooms: _____ Date of arrival: _____

Number of guests in room: _____ Approx. time of arrival: _____

Number of nights: _____ Date of departure: _____

1 King-sized Bed: _____ or 2 Double Beds: _____

Name: _____

Address: _____

City: _____ State: _____ Zip: _____ - _____

Phone: _____ Fax: _____ E-mail: _____

Signature: _____ Date: _____

CONFERENCE REGISTRATION FORM

“Dedication Makes the Difference”

Name: _____

Address: _____

City: _____ State: _____ Zip: _____ - _____

E-mail: _____ Phone: _____

Please include your email address and phone number in case we have questions about your registration, etc. It's very important that we can get in touch with you promptly.

Please specify your title and organization if you would like to have them on your nametag.

Title: _____ Organization: _____

Registration:

_____ Member/Associate Member (\$30.00) postmarked BEFORE 04/06/09 _____

_____ Member/Associate Member (\$40.00) postmarked AFTER 04/06/09 _____

_____ Non-Member (\$50.00) postmarked BEFORE 04/06/09 _____

_____ Non-Member (\$60.00) postmarked AFTER 04/06/09 _____

_____ One-Day Non-Member/Never Attended OR Spouse
and/or Companion (\$10.00) _____

_____ VAVF Luncheon (\$21.00) _____

_____ Hotel Fees (\$99.00 per night) _____

TOTAL CONFERENCE FEES (*Make checks payable to: VAVF, Inc.*) _____

Mail registration form, session preference form, and check to:

VAVF, Inc.
c/o Arlene Jensen
6425 Streamport Dr.,
Orlando, FL, 32822-3066

HOTEL RESERVATION INFORMATION

The following information is important for VAVF. It will give us information we need to confirm the number of rooms reserved in the VAVF block. Please be sure to mention VISUAL AID VOLUNTEERS OF FLORIDA (VAVF) CONFERENCE when making your reservation.

_____ I am reserving a room in my name for _____ nights.

_____ I will be sharing a room reserved under another name for _____ nights.

_____ I will not be staying at the hotel.

LUNCHEON CHOICES AND SESSION PREFERENCE FORM

Name: _____

Address: _____

E-mail: _____ Phone: _____

I Need Workshop Materials in Braille: _____ in Large Print: _____.

I am a(n) Volunteer: _____ Educator: _____ Administrator: _____ Other: _____.

LUNCHEON CHOICES (CHOOSE ONE)

- _____ 1 Chicken Marsala
 _____ 2 Vegetarian Baked Pasta

SESSION PREFERENCES

*Check both sides of this form. Sessions go from #101-#303.
 Handouts will go first to those who signed up for that session by April 6, 2009!*

MONDAY, April 20, 2009

- _____ 101-A Creating Collages
 _____ 102-A Handouts from Alternate Sources
 _____ 103 BRL2000 for Beginners
- _____ 101-B Creating Collages (cont.)
 _____ 102-A Handouts from Alternate Sources (cont.)
 _____ 104 The Trial Manuscript
- _____ **105 VAVF Luncheon and Installation of Officers**
- _____ 106-A BRL2000 Version 2: Overview
 _____ 107 Lower Grades Math
 _____ 108 Literary Oddities
- _____ 106-A BRL2000 Version 2: Overview (cont.)
 _____ 109 Common Errors Found at FIMC
 _____ 110 Proofreading

TUESDAY, April 21, 2009

_____ 201-A BRL2000 Version 2: Overview Hands-On
 _____ 202-A Fun with Computer Graphics; Hands-on
 _____ 203 Independent Living; How Do You Do It Without Looking?

_____ 201-B BRL2000 Version 2: Overview Hands-On (cont.)
 _____ 202-B Fun with Computer Graphics; Hands-on (cont.)
 _____ 204 Technology for Blackboard & Music Software

Lunch On Your Own

_____ 205 Graphics Analysis
 _____ 206 Organizing Files
 _____ 207-A Handouts from Alternate Sources {Repeat}

_____ 208 How to Trace Maps in Word
 _____ 209 Volunteer Group Management
 _____ 207-B Handouts from Alternate Sources {Repeat}(cont.)

WEDNESDAY, April 22, 2009

_____ 301-A Fun with Computer Graphics; Hands-on {Repeat}
 _____ 302 Multilanguage Glossaries; New Format Suggestions

_____ 301-B Fun with Computer Graphics; Hands-on {Repeat} (cont.)
 _____ 303 Scanning for Beginners

Conference Over**VOLUNTEER-TO-HELP FORM**

The **Registration Table** needs volunteers to hand out name tags, etc. to our attendees. When can you help us out?

Monday: 7:30-8:30 _____ 8:30-10:00 _____ 10:00-10:30 _____ 10:30-12:00 _____

2:00-3:30 _____ 3:30-4:00 _____ 4:00-5:30 _____

Tuesday: 7:30-8:30 _____ 8:30-10:00 _____ 10:00-10:30 _____ 10:30-12:00 _____

2:00-3:30 _____ 3:30-4:00 _____ 4:00-5:30 _____

Wednesday: 7:30-8:30 _____

CONTRIBUTION (Memorial Scholarship Fund)

Name: _____
 Address: _____
 City/State/Zip: _____
 Amount: \$ _____ payable to VAVF, Inc. In memory/honor of: _____

Send to: VAVF, Inc., c/o Arlene Jensen, Treasurer, 6425 Streamport Dr., Orlando, FL, 32822-3066

If there is a special occasion, such as a birthday or anniversary, or if the contribution is in memory/honor of, please fill in the information below and a card will be sent to the family of/honoree with your brief message.

Name: _____
 Address: _____
 City/State/Zip: _____
 Occasion/Brief Message: _____

MEMBERSHIP APPLICATION OR RENEWAL

Membership in VAVF is based on the calendar year--January-December. If you wish to join the statewide organization, please fill in the categories shown below on the membership application form and send it to

VAVF, Inc., c/o Arlene Jensen, Treasurer, 6425 Streamport Dr., Orlando, FL, 32822-3066

Name: _____
 Address: _____
 City/State/Zip: _____
 E-mail: _____ Phone: _____

My specialties are: (*Certification Year or* \checkmark *if working in but not certified in:* _____)
 BRAILLE: Literary: _____ Textbook: _____ Translation Typing: _____
 Nemeth: _____ Music: _____ Foreign Language: _____
 RECORDING: _____
 GRAPHICS: _____
 LARGE TYPE: _____
 OTHER: _____

I need: braille _____ large print _____.

FEES: \$15.00 Regular Membership _____
 \$20.00 Booster Membership _____
 \$5.00 Associate Membership (spouse or other family members who accompany
 braillists/tapists/other media users to conferences) _____
 \$150.00 Lifetime Membership (may be paid in installments over 3 years) _____

Indicate total amount paid: \$ _____ payable to VAVF, Inc.